

## EN WHY-KP

### SELF-LEARNING UNIVERSAL WIRELESS KEYPAD

Cod. WHITE 8991007 • BLACK 8991008

#### Instruction manual and warnings

For your safety, please read manual instruction carefully before beginning installation.

#### Technical Specifications

Power supply: 1 x CR2450 3V

Storable codes: up to 12

Users: 1 master + up to 11 standard

Frequency: MultyAM/FM

Code types: fixed and rolling code

Working temperature: -20°/+60°C

Size: 98x73x43 mm



#### USER MANUAL

**S** The PASSWORD MASTER is unique and is necessary to memorize the codes to be transmitted from the Keypad and to manage the different PASSWORD USER. **PLEASE NOTE PASSWORD MASTER is pre-set with code 1111.**

#### HOW TO MODIFY THE PASSWORD MASTER

Digit the valid PASSWORD MASTER and keep pressed the last button (1 in case of first modification) for at least 6 seconds.

RED and GREEN led will light on with steady light and the buzzer will emit a short sound.

Now press "0" button, RED led remains lighted on while GREEN starts blinking slowly.

At this point digit the new desired PASSWORD MASTER by using between 4 and 8 characters (note that you can use both numbers between 0-9 than letters A-B).

If the PASSWORD is usable the GREEN led will light on steady while the RED turns off.

Digit the new PASSWORD MASTER a second time as to confirm. The RED led lights on steady while the GREEN blinks slowly. If the password matches with the first digitated then the RED led stays the same while the GREEN blinks faster.

#### PASSWORD USER

Can be set up to 11 PASSWORD USER.

To set or modify a PASSWORD USER digit the PASSWORD MASTER and keep the last button pressed for at least 6 seconds.

RED and GREEN led will light on with steady light and the buzzer will emit a short sound.

Now press the button with which you want to manage this PASSWORD USER (choose between 1-9 and A-B not 0 as reserved to the PASSWORD MASTER). The RED led lights on steady while the GREEN blinks slowly.

At this point digit the desired PASSWORD USER by using between 4 and 8 characters (note that you can use both numbers between 0-9 than letters A-B).

If the PASSWORD is usable RED and GREEN LEDs will light on steady and you can choose radio codes (previously set) to enable for this PASSWORD USER by pressing one at a time the desired buttons.

If no buttons is pressed within 10 seconds, all the codes previously set will be enabled automatically.

Now the RED led is lighted on steady while GREEN blinks quickly at indicate that the procedure has been successfully concluded.

We strongly recommend to take note of the PASSWORD MASTER and keep it in a safe place in order to have always access into the system.

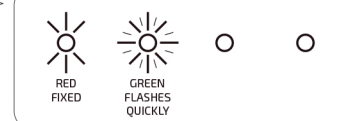
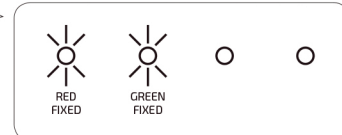
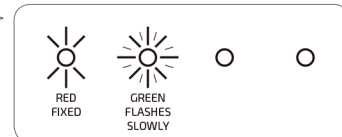
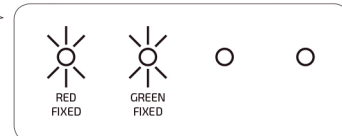
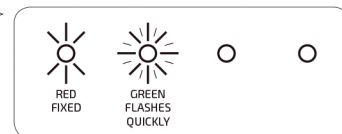
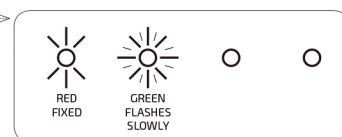
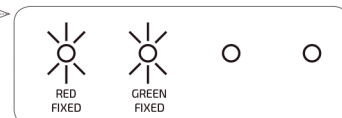

## RADIO CODES SETTING

To check and/or download the updated complete compatibilities list please visit [why-evo.com](http://why-evo.com)

1. Digit the PASSWORD MASTER. The GREEN led lights on steady.
2. Press button 1 and keep it pressed, then press 4 times button 2 and release both.
3. GREEN led blinks slowly to indicates is waiting for a code to be received. Place the source remote control at about 1 cm distance to the Keypad and press the button you desire to copy.

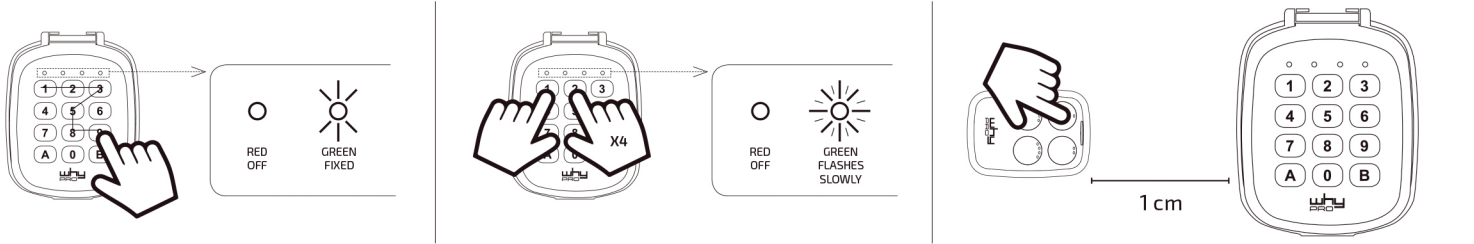

- If the RED led will start blinking quickly, means the code has been correctly received. Press the desired button on the keypad where you want to store this code, the RED led passes to steady, wait until it will turn off at indicate that the procedure has been successfully concluded.



- If the GREEN led will emit a double blink means to complete the procedure the Keypad needs also the SEED CODE (Please visit [why-pro.com](http://why-pro.com) for further details).

Now digit the PASSWORD MASTER and then the button where the code has been stored in, and:

- If the desired automation starts working the procedure is completed.
- If the desired automation doesn't start working, press and keep pressed for at least 8 seconds the button where the code has been stored, the RED led starts blinking at indicates the **D.O.R.** technology has been enabled, trying to insert the new code on the related receiver. At the end of this automatic procedure the RED led will turn off. Digit again the PASSWORD MASTER and press the desired button to check if the automation starts. If it does, the procedure is concluded otherwise means the receiver is disabled to receive any additional code through "via radio" mode. In this case need to refer to the manual instruction of the automation installed and follow related procedures that explain how to add new remote controls manually.

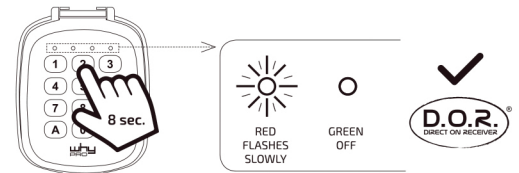

### NOTE: THE SEED CODE FROM THE KEYPAD CAN BE EMITTED AS FOLLOW:

- Digit the password master
- Press simultaneously buttons 1 and 2 for at least 4 seconds and release both when the red led starts to blink
- Within 10 seconds press the button interested to emit its seed code.



### ERROR MESSAGE

If during SET/MODIFICATION password procedure an invalid password is digitated (too short or too long) or an already existing password in the system, thus non-usable, the Keypad notifies the error by emitting a pulsed sound with GREEN led lighted on steady and RED that blinks quickly. This error message can also be emitted in case of mistakes during the radio code setting procedures.

### DAILY USE

To light up the Keypad press any buttons for at least 3 seconds.

To activate the keypad to usage, digit any of the passwords set: the GREEN LED lights on at indicate the Keypad is unlocked.

If a wrong code is digitated, simply repeat the procedure and digit a correct one.

Once the Keypad has been unlocked you have 6 seconds within which press the desired button and transmit the related code: the RED led lights on and a short sound indicates the code is in transmission. After the transmission the keypad stays unlocked for further 6 seconds to allow the user send another code if desired.

NOTE: The PASSWORD MASTER is always enabled to send any of the codes stored into the keypad. Any of the PASSWORD USER is enabled to send only the codes previously set for that password.

The universal wireless keypad why-kp complies with the following directives 2014/35/EU • 2014/30/EU • RED 2014/53/EU.